

3Ac PERMIT  
STORMWATER  
UPGRADES  
REQUIRED  
EST. #0.5 I.D.M.

STONE HIGHWAY  
WWTAP

DEPOT ST +  
THOMAS LANE (E) DRAIN  
TO ADJUTING WETLANDS  
+ CULVERT OUTLET TO  
NORTH - NOT PERMIT OUTLET  
TO SOUTH

COPELY WOODLANDS  
2.9 AC ± IMP.  
DRAINS TO  
TOWN HIGHWAY  
**NOT IN**

STONE  
MEMORIAL  
PARK  
**IMPACT FEE 2 \$600<sup>K</sup>**

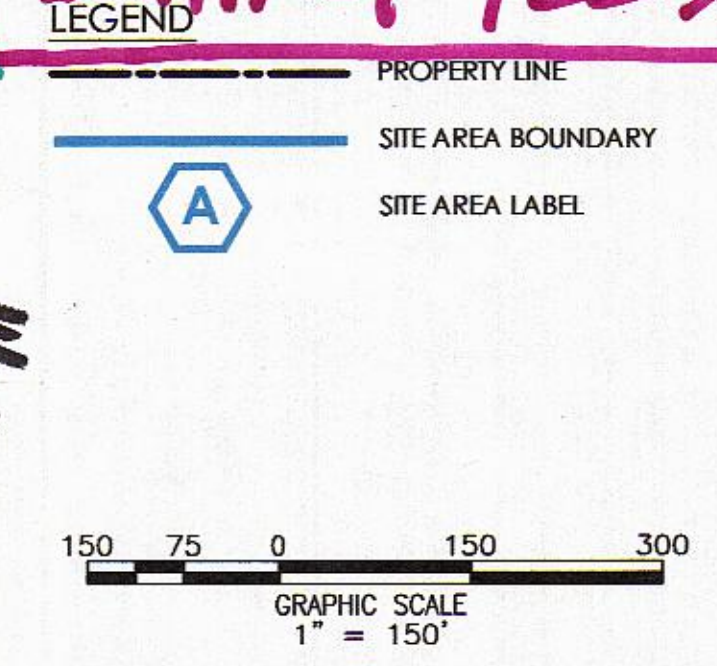

Simons  
Brook

**NOT IN  
PHASES III + IV**

**NOT IN  
PHASE II  
DRAINS IN PART  
TO PHASE I**

**IN  
THOMAS LANE - PHASE I  
FULL BURDEN OF STORMWATER  
INFRASTRUCTURE, EX E PROP.**

ORIG. DEVELOP.  
PRE STORMWATER  
1.0 AC ± IMP.  
**NOT IN**

Site Letter	Site Description	Owner/Permittee	Site Area (acres)	Impervious Area (acres)	Percent of Total Impervious Area
A	Mansfield House, Mill House, Parking Lots	Ampersand Properties, Ltd.	2.418	1.553	23%
B	Depot Street Townhouses	Depot Street Townhouse Condominiums Owners Association, Inc.	2.671	1.100	16%
C	Depot Street, Depot Street Extension, Thomas Lane Town Highway	Town of Stowe	3.893	2.294	35%
D	Thomas Lane Phase 1, Commercial Lot B	Rural Properties LLC	1.535	0.241	4%
E	Thomas Lane Phase 1, Commercial Lot A (174 Thomas Lane #3)	Stowe Cable Properties LLC	2.333	0.542	8%
F	Thomas Lane Phase 1, Commercial Lot C (198 Thomas Lane #1)	Larry Sands	0.649	0.142	2%
G	Thomas Lane Phase 1, Lots 1-8	Thomas Lane Homeowners Association, Inc.	3.215	0.690	10%
<b>Total:</b>			<b>16.714</b>	<b>6.562</b>	<b>100%</b>



TCE, a BOWMAN Company  
478 Blair Park Rd.  
Williston, Vermont 05495  
Phone: (802) 879-6331  
www.tbwm.com  
© 2024 Bowman Consulting Group Ltd

**IMPERVIOUS AREA MAP**  
AMPERSAND STOWE 3-ACRE  
DEPOT STREET EXTENSION & THOMAS LANE TOWN HIGHWAY, STOWE, VT

24-095  
PROJECT NUMBER

PLAN STATUS		
DATE	DESCRIPTION	
CML DESIGN	JGE DRAWN	AAD CHKD
SCALE 1" = 150'		
JOB No. 24-095		
DATE: 10/31/2024		

**C-2.0**