

# WOMEN'S CORRECTIONAL AND RE-ENTRY FACILITIES

DEPARTMENT OF BUILDINGS AND GENERAL SERVICES

House Committee on Corrections and Institutions: February 1, 2023

Project Manager Tabrena Karish

# CRIMINAL JUSTICE REFORM STRATEGIES

AS PART OF THE  
JUSTICE REINVESTMENT II INITIATIVE

- Assess the population trends, programming and the infrastructure needs
- Evaluation of multiple-in-state locations, a campus style facility, and a combination of both
- Efficiency of capacity, treatment/programming, operating and capital costs, and transitional supports needed for successful community re-integration
- Specific evaluation of the women's facility

# PROJECT GOALS



HOUSE ALL VERMONT INMATES  
WITHIN VERMONT FACILITIES  
AND ADDRESSING GROWING  
OFFENDER POPULATIONS



RESTRUCTURE THE SYSTEM TO  
BRING VERMONT'S CRIMINAL  
JUSTICE SYSTEM IN LINE WITH  
NATIONAL STANDARDS



RESTRUCTURE THE SYSTEM IN  
PROMOTION OF REDUCING  
PRISON POPULATIONS AND  
RECIDIVISM



INTRODUCE RE-ENTRY  
FACILITY AND IMPROVE  
OFFENDER OUTCOMES



# Chittenden Regional

## Correctional Facility (CRCF)



Est.



### ESTABLISHED

- BUILT 1974
- ADDITION IN 1983 TO PHYSICAL PLANT, LIVING UNITS, AND OFFICE SPACE



### AREA

- 51,211 GSF
- 6.02 ACRES



### POPULATION

- 177 BED CAPACITY
- ALL FEMALE FACILITY

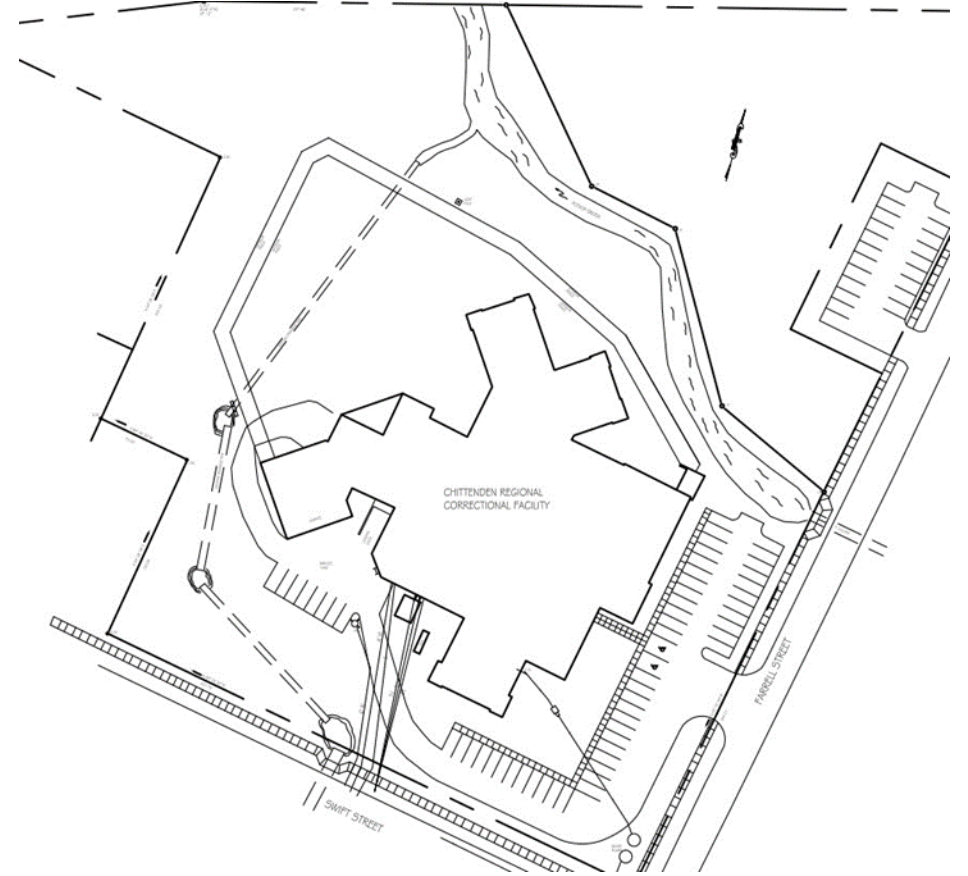



# Existing Conditions

Chittenden Regional  
Correctional Facility (CRCF)







# Existing Conditions

Chittenden Regional  
Correctional Facility (CRCF)



# GOALS

GENDER RESPONSIVE CARE  
SAFE AND SECURE  
TRAUMA – INFORMED CARE  
STAFF WELLNESS  
LIGHT-FILLED  
ACOUSTICS  
BUILDING TECHNOLOGY  
STAFF/ PERSON IN CUSTODY TECHNOLOGY  
VOCATIONAL PROGRAMS BOTH FOR PERSONS IN CUSTODY  
AND STAFF – INDIVIDUAL VS GROUP, MORE OPTIONS  
COMMUNITY SPECIFIC  
TRANSGENDER SERVICES  
IMPACT OF MAT  
MENTAL HEALTH SERVICES  
SUBSTANCE ABUSE SERVICES  
HEALTH SERVICES/ MEDICAL SERVICES / INFIRMARY / RESILIENT  
BED TYPES  
EDUCATION

- WELL BUILDING
- LEED
- TRAUMA-INFORMED DESIGN
- GENDER RESPONSIVE DESIGN
- FLEXIBILITY IN HOUSING TYPES – STEP-UP/  
STEP-DOWN
- MAINTENANCE A PRIORITY
- DURABLE MATERIALS
- EFFICIENCY OF STAFFING
- FLEXIBILITY IN STAFFING MODELS  
(DIRECT/INDIRECT MODEL)
- VISITATION/ FAMILY REUNIFICATION





# TRAUMA INFORMED CARE







# Vision

- Provide appropriate types of housing for the different classifications and treatment needs of incarcerated individuals being held



# Vision

- Create calming, open spaces that enhance individual's well-being through biophilic design principles including natural elements, calming color palettes, natural light and connection to the outdoors.

San Mateo, CA  
Reentry, Programs, Reunification



# TRAUMA-INFORMED SPACES





# SLEEPING SPACES





# WOMEN'S FACILITIES





# PROGRAM SPACES

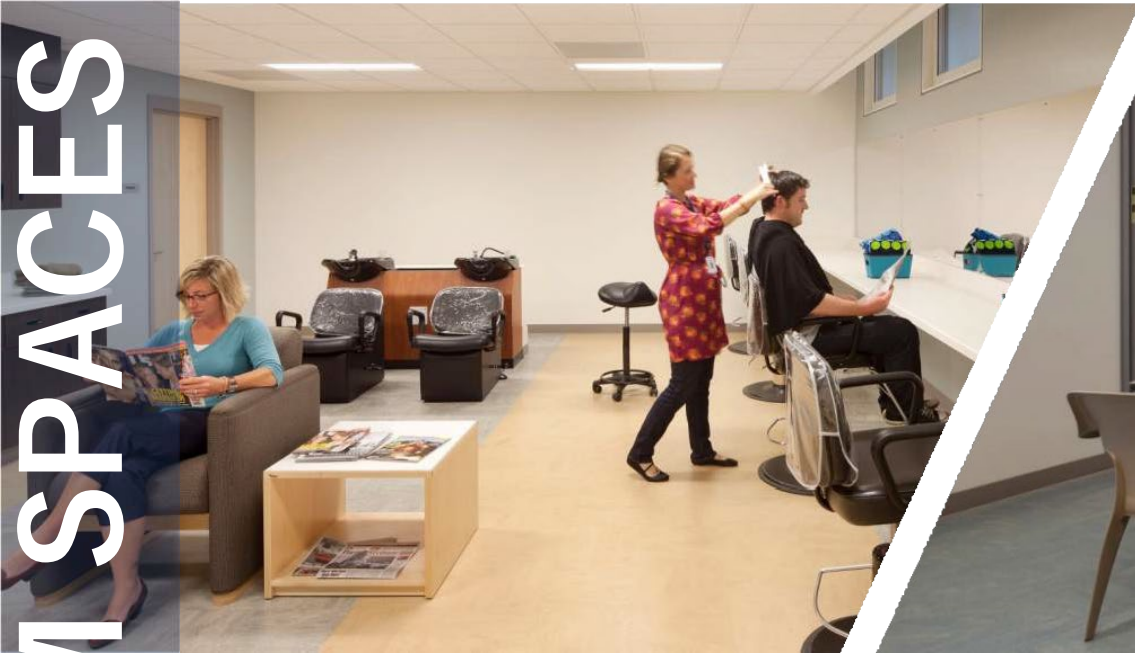



# RE-ENTRY SPACES



PROJECT PHASES	
PROGRAMMING AND CONCEPTUAL DESIGN	<ul style="list-style-type: none"> <li>Establish priorities and objectives</li> <li>Confirm space and functional needs</li> <li>Develop basic diagrams that illustrate adjacencies, functional efficiencies and anticipated circulation</li> </ul>
SCHEMATIC DESIGN	<ul style="list-style-type: none"> <li>Further develop the shape and size of the building</li> <li>Determine how the building will look and operate</li> <li>Develop the general plan and basic exterior design</li> </ul>
DESIGN DEVELOPMENT	<ul style="list-style-type: none"> <li>Select materials including interior finishes and products</li> <li>Choose engineering structure, MEP energy analysis and any other project specific systems</li> <li>Revise the drawings with more specificity and detail</li> <li>Concludes when the interior and exterior design of the building is locked in by the owner and architect</li> <li>Any layout changes after this point are an additional service</li> </ul>
CONSTRUCTION DOCUMENTS	<ul style="list-style-type: none"> <li>Architect and engineers finalize all the technical design and engineering</li> <li>All products and materials are selected and scheduled</li> <li>All construction details are finalized</li> <li>Any layout or significant changes from DD are an additional service.</li> </ul>
CONSTRUCTION	<ul style="list-style-type: none"> <li>Any deviation from the construction documents is a change order and will incur additional fees from the Construction Manager, subcontractors, and Design Team</li> </ul>
FITUP	<ul style="list-style-type: none"> <li>Furnishings, Equipment</li> <li>Owner Completed Construction</li> <li>Security, ADS, Utilities</li> </ul>



Co-locate the secure facility and re-entry facility

- \* Operational efficiency
- \* Staffing & service efficiency
- \* Upfront cost savings
- \* Shortened timeline to operation

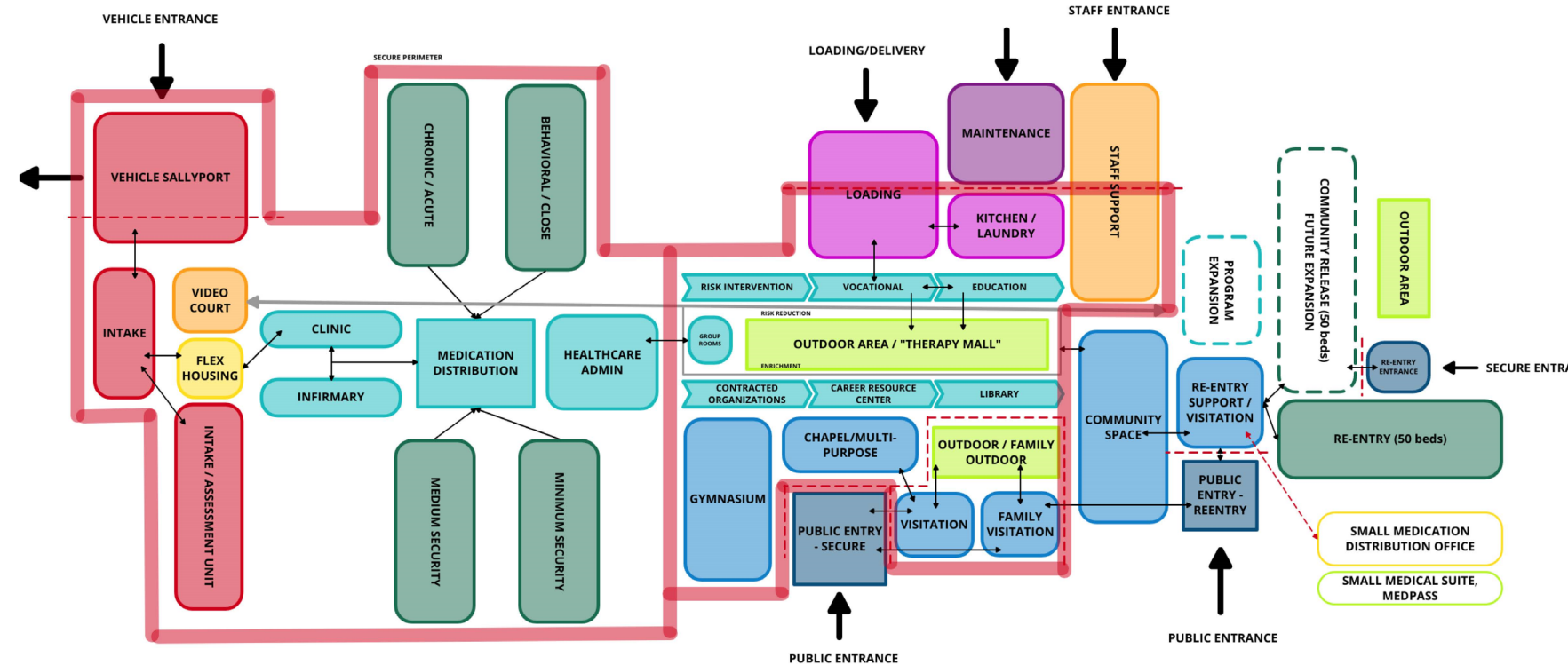

## VERMONT WOMENS CORRECTIONAL AND RE-ENTRY









A100

ADJACENCY DIAGRAM

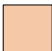

2023-10-13 8:35:53 PM  
00.00000.00

LEGEND

	CIRCULATION
	COURTYARD
	MAINTENANCE
	LIVING AREA
	SHOWERS
	SLEEPING AREA
	TREATMENT SUPPORT



VERMONT WOMENS CORRECTIONAL AND RE-ENTRY FACILITY



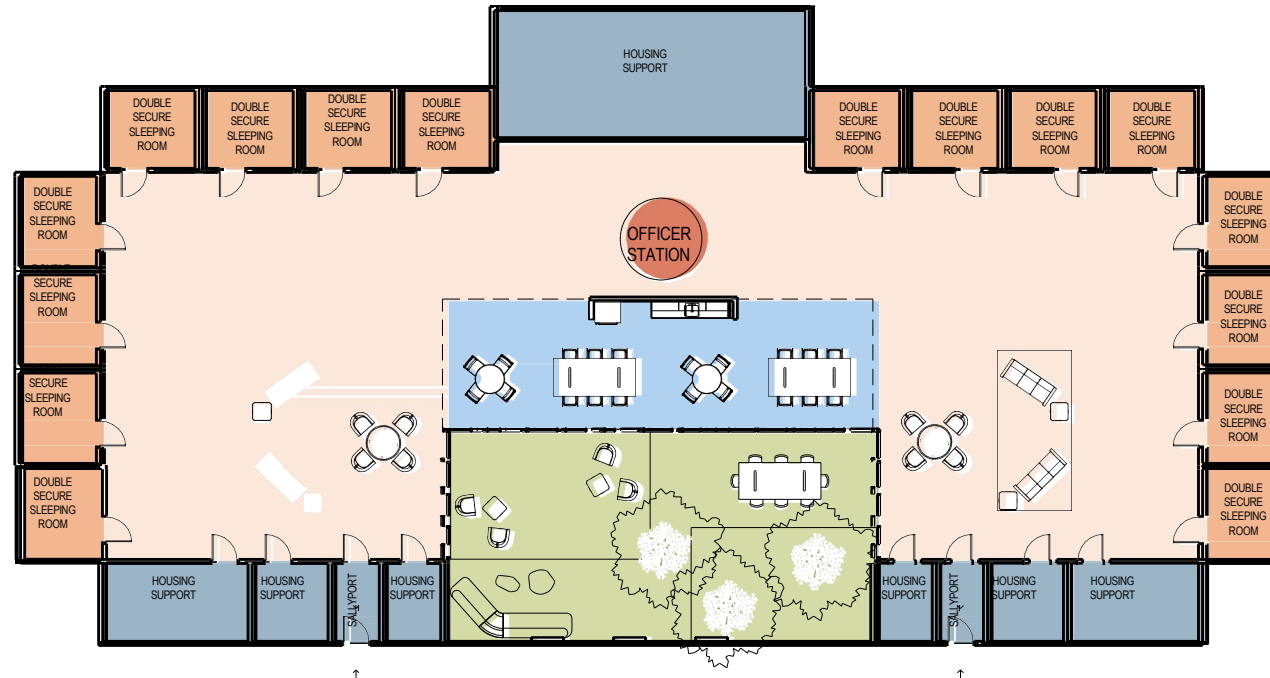

VERMONT WOMENS CORRECTIONAL AND RE-ENTRY FACILITY

SECURE RESIDENTIAL TREATMENT FACILITY									
SECURE FACILITY						COMBINED	RE-ENTRY		
RATED BED CAPACITY			ADDITIONAL OPERATIONAL BED CAPACITY				RATED CAPACITY		
UNIT	CAPACITY (BEDS)	CONFIGURATION	UNIT	CAPACITY (BEDS)	CONFIGURATION		UNIT	CAPACITY (BEDS)	CONFIGURATION
CLOSE	8	SINGLE, SECURE SLEEPING ROOM	INTAKE	7	2 SINGLE, 2 GROUP (4)HOLDING CELLS	COMBINED	COMMUNITY RELEASE (WORK RELEASE /RE-ENTRY	30	DOUBLE SLEEPING ROOM, POD CONFIGURATION OF 10 BEDS
MEDIUM	40	DOUBLE SECURE SLEEPING ROOM	INCAP	2	1 SINGLE SECURE SLEEPING ROOM		RE-ENTRY (EXPANSION)	(50 BEDS)	DOUBLE SLEEPING ROOM, POD CONFIGURATION OF 10 BEDS
MINIMUM	40	DOUBLE SLEEPING ROOM	ASSESSMENT	10	DOUBLE SECURE SLEEPING ROOM				
LONG TERM/CHRONIC MEDICAL	5	DOUBLE SECURE SLEEPING ROOM (SPACE FOR (CAREGIVER))	INFIRMARY	4	SINGLE ISOLATION				
ACUTE MENTAL HEALTH	5	SINGLE SECURE SLEEPING ROOM, WITH SUBDAYROOM	FLEX HOUSING	4	2 SECURE SLEEPING ROOMS WITH 2 BEDS				
BEHAVIORAL MENTAL HEALTH	10	SINGLE CELLS WITH SUBDAYROOM							
HONORS HOUSING	20	POD OF 20, SINGLE SLEEPING ROOM							
RATED BED CAPACITY	128		ADDITIONAL OPERATIONAL BED CAPACITY	27			RATED BED CAPACITY	30	