

Calais.

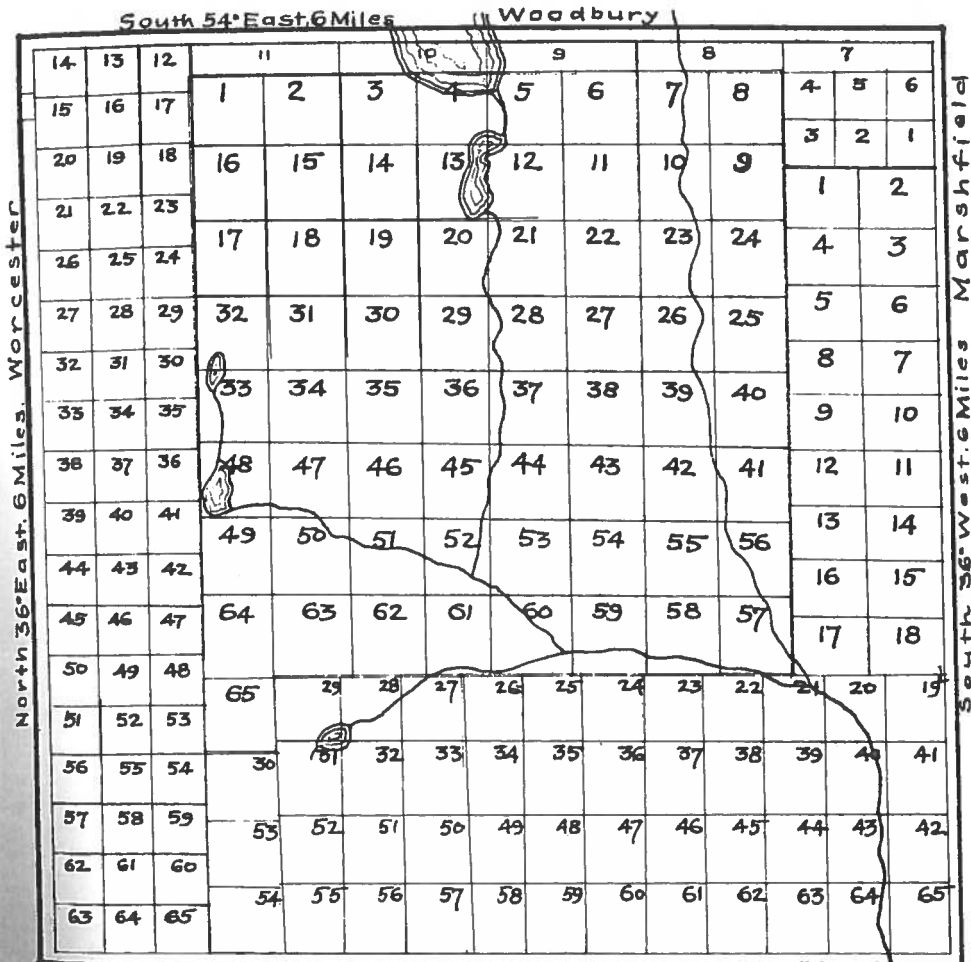

1st, 2d, 3d
 50 42 61
 19 28 4
 57 40 53
 49 44 41
 49 29 42
 54 45 33
 12 39 10
 16 40 25
 4 15
 20 34 6
 22 23 3
 40 11 49
 52 8 19
 13 26 59
 15 1 29
 34 20 46
 29 10 9
 niel, 7 7
 2 31 27
 s,
 17 49 32
 45 50 56
 39 15 37
 60 35 26
 61 18 16

 50 Acres;
 112 Acres;
 77 Acres.
 38, 40, 48, 51 & 55
 Division are set to
 not in the second
 lots.
 1 Proprietors
 the Second and
 who have none in

 in the GRANTS

Sewark.

A true copy from the
 Saml. C. Crafts Book of Plans,
 made, March 21, 1910, by
 Burlington, Vt. *F. D. Sewark.*

South 54° East, 6 Miles
 Montpelier

Lotting Map

***** H A F T		O F C A L A I S *****		*****	
DIVISIONS,		1st, 2d, 3d	DIVISIONS,		1st, 2d, 3d
Arwidown, Caleb,	8	8	5	Starkweather, Oliver,	50 42 61
Bacon, Daniel,	56	55	12	Stone, Nehemiah,	18 28 4
Clark, Ebenezer A.,	4	60	28	Stone, Nehemiah, Jr.,	57 40 53
Coburn, Richard,		37	34	Stroeter, Daniel,	51 44 41
Cummings, William,		61	39	Taft, Peter,	49 29 42
Davis, Sarah,	3	32	58	Thompson, Elisha,	54 45 33
Davis, Jacob,	19	57		Town, Elisha,	12 39 10
Davis, Ezra,	64	22	51	Town, Salem,	16 40 25
Davis, Jessc,		27	14	Town, Joseph,	4 15
Dorr, Joseph,	40	6	52	Tyler, Nathan,	20 34 6
Edwards, Lemuel,	27	53	11	Tucker, Jonathan,	22 23 3
Ely, Justin,	63	2	22	Ware, William,	43 11 49
Fay, Stephen,	24	64	65	Washburn, Seth,	52 8 19
Fay, Samuel,	32	52	48	Wheelock, Peter,	13 26 59
Fay, David,	35	12	17	Wheelock, David,	15 1 29
Fisk, David,	14	51	57	Whitefield, Ebenezer,	34 20 46
Fisk, Henry, Jr.,	5	17	62	Wheelock, Eli,	29 10 9
Fosket, Thomas,	30	21	21	Whittington, Nathaniel,	7 7
Goodell, Abel,	53	9	30	Wolcott, Edward,	2 31 27
Goodman, Noah,	26	59	55	Public Rights,	
Hammond, David,	7	58	36	College,	17 49 32
Jennis, Amos,	11			Support of Gospel,	45 50 56
Jones, Eli,		16	20	Minister,	32 15 37
Lamb, Ebenezer,		14	8	Grammar School,	60 35 26
Lamb, Abijah,		65	38	Town School,	61 18 16
Mam, Bezaleel,	37	47	24	*****	
Marcy, John,	41	62	31	First Division, 160 Acres;	
Mower, John,	58	24	13	Second Division, 112 Acres;	
Mower, Marvin,		33	20	Third Division, 77 Acres.	
Ollen, Abner,		63	50	Lots N ^o 25, 28, 31, 32, 40, 48, 51 & 55	
Pecke, Shubal,	23	48	40	in the First Division are set to	
Robinson, Samuel,	44	13	6	Jacob Davis, but not in the second	
Rollock, Lemuel,	36	54	63	and Third Divisions.	
Rutter, Job,	6	56	44	There are several Proprietors	
Rider, Isaiah,		38	1	who have lots in the Second and	
Rich, Jonathan,	47		43	Third Divisions, who have none in	
Slayton, Phineas, Jr.,	42	3	18	the First.	
Slayton, Phineas,	59	30	47	*****	
Sluman, Peter,	1	5	23		
Starkweather, Ephraim,	9	25	54	A true copy from the CALAIS	
Starkweather, John,	33	41	35	Book of Plans.	

Attest:
J. H. Dewarck

North 36° East. 6 Miles Worcester