

WOMEN'S CORRECTIONAL AND RE-ENTRY FACILITIES

DEPARTMENT OF BUILDINGS AND GENERAL SERVICES

Senate Committee Institutions: February 9, 2023

Project Manager Tabrena Karish

CRIMINAL JUSTICE REFORM STRATEGIES

AS PART OF THE JUSTICE REINVESTMENT II INITIATIVE

- Assess the population trends, programming and the infrastructure needs
- Evaluation of multiple-in-state locations, a campus style facility, and a combination of both
- Efficiency of capacity, treatment/programming, operating and capital costs, and transitional supports needed for successful community re-integration
- Specific evaluation of the women's facility

PROJECT GOALS



HOUSE ALL VERMONT INMATES
WITHIN VERMONT FACILITIES
AND ADDRESSING GROWING
OFFENDER POPULATIONS



RESTRUCTURE THE SYSTEM TO
BRING VERMONT'S CRIMINAL
JUSTICE SYSTEM IN LINE WITH
NATIONAL STANDARDS



RESTRUCTURE THE SYSTEM IN
PROMOTION OF REDUCING
PRISON POPULATIONS AND
RECIDIVISM



INTRODUCE RE-ENTRY
FACILITY AND IMPROVE
OFFENDER OUTCOMES

Chittenden Regional Correctional Facility (CRCF)

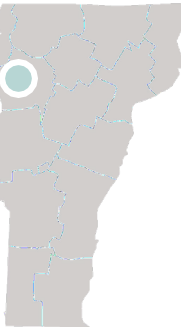

ESTABLISHED

- BUILT 1974
- ADDITION IN 1983 TO PHYSICAL PLANT, LIVING UNITS, AND OFFICE SPACE



AREA

- 51,211 GSF
- 6.02 ACRES



POPULATION

- 177 BED CAPACITY
- ALL FEMALE FACILITY

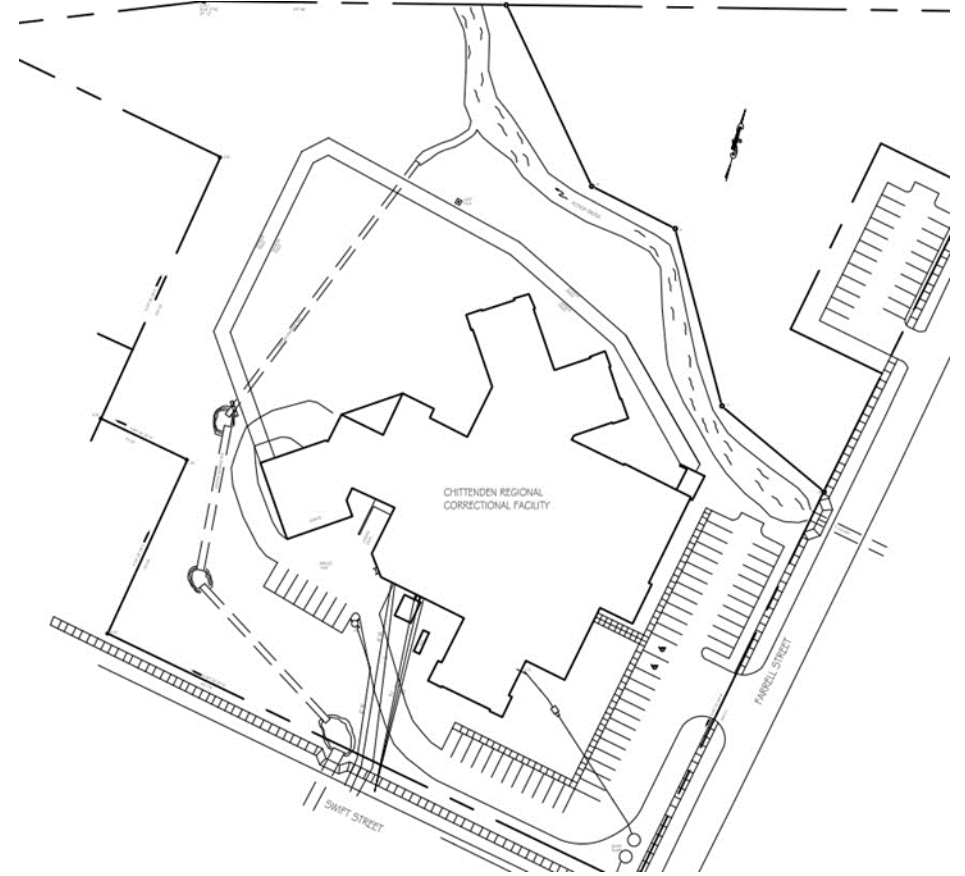



Existing Conditions

Chittenden Regional
Correctional Facility (CRCF)



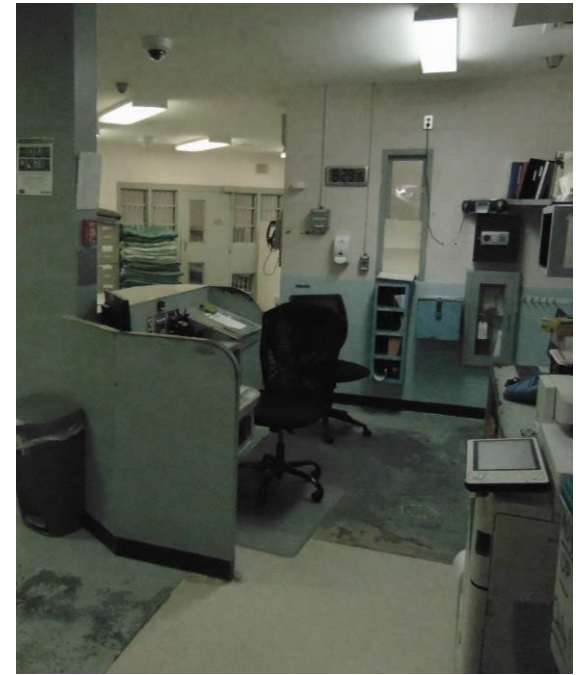

Existing Conditions

Chittenden Regional
Correctional Facility (CRCF)

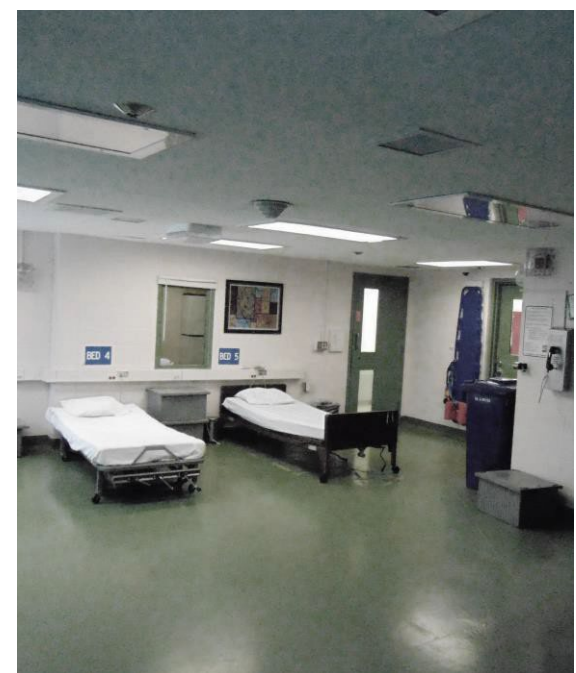

GOALS

GENDER RESPONSIVE CARE
SAFE AND SECURE
TRAUMA – INFORMED CARE
STAFF WELLNESS
LIGHT-FILLED
ACOUSTICS
BUILDING TECHNOLOGY
STAFF/ PERSON IN CUSTODY TECHNOLOGY
VOCATIONAL PROGRAMS BOTH FOR PERSONS IN CUSTODY
AND STAFF – INDIVIDUAL VS GROUP, MORE OPTIONS
COMMUNITY SPECIFIC
TRANSGENDER SERVICES
IMPACT OF MAT
MENTAL HEALTH SERVICES
SUBSTANCE ABUSE SERVICES
HEALTH SERVICES/ MEDICAL SERVICES / INFIRMARY / RESILIENT
BED TYPES
EDUCATION

- WELL BUILDING
- LEED
- TRAUMA-INFORMED DESIGN
- GENDER RESPONSIVE DESIGN
- FLEXIBILITY IN HOUSING TYPES – STEP-UP/
STEP-DOWN
- MAINTENANCE A PRIORITY
- DURABLE MATERIALS
- EFFICIENCY OF STAFFING
- FLEXIBILITY IN STAFFING MODELS
(DIRECT/INDIRECT MODEL)
- VISITATION/ FAMILY REUNIFICATION

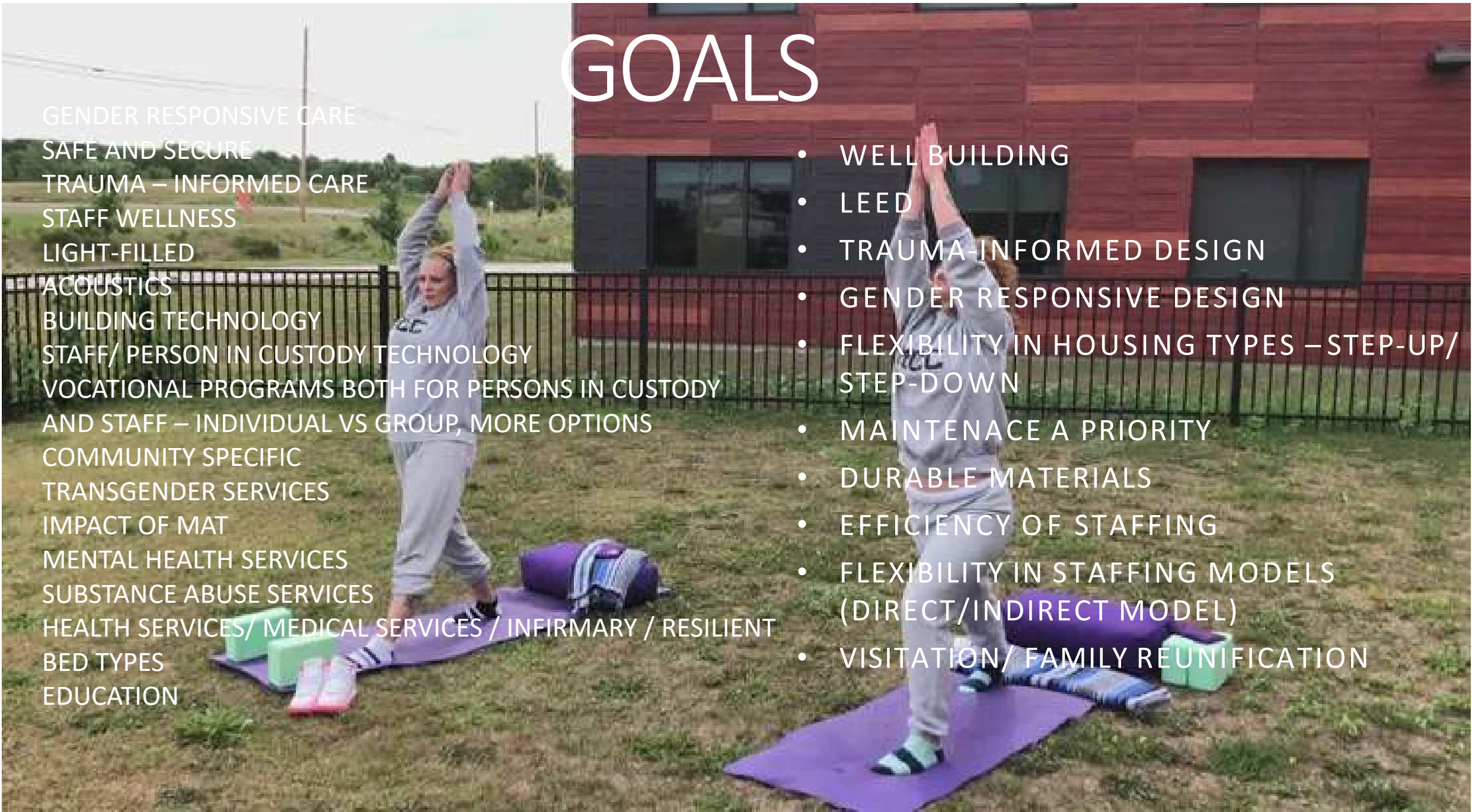

TRAUMA INFORMED CARE

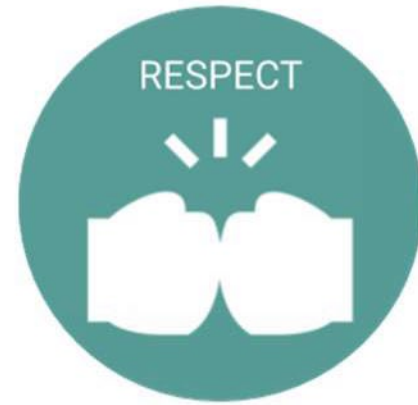

PRINCIPLES
OF
TRAUMA
INFORMED
CARE





Vision

- Provide appropriate types of housing for the different classifications and treatment needs of incarcerated individuals being held

Vision

- Create calming, open spaces that enhance individual's well-being through biophilic design principles including natural elements, calming color palettes, natural light and connection to the outdoors.

San Mateo, CA
Reentry, Programs, Reunification

TRAUMA-INFORMED SPACES



SLEEPING SPACES



WOMEN'S FACILITIES



PROGRAM SPACES



RE-ENTRY SPACES



PROJECT PHASES

PROGRAMMING AND CONCEPTUAL DESIGN

- Establish priorities and objectives
- Confirm space and functional needs
- Develop basic diagrams that illustrate adjacencies, functional efficiencies and anticipated circulation

SCHEMATIC DESIGN

- Further develop the shape and size of the building
- Determine how the building will look and operate
- Develop the general plan and basic exterior design

DESIGN DEVELOPMENT

- Select materials including interior finishes and products
- Choose engineering structure, MEP energy analysis and any other project specific systems
- Revise the drawings with more specificity and detail
- Concludes when the interior and exterior design of the building is locked in by the owner and architect
- Any layout changes after this point are an additional service

CONSTRUCTION DOCUMENTS

- Architect and engineers finalize all the technical design and engineering
- All products and materials are selected and scheduled
- All construction details are finalized
- Any layout or significant changes from DD are an additional service.

CONSTRUCTION

- Any deviation from the construction documents is a change order and will incur additional fees from the Construction Manager, subcontractors, and Design Team

FITUP

- Furnishings, Equipment
- Owner Completed Construction:
- Security, ADS, Utilities





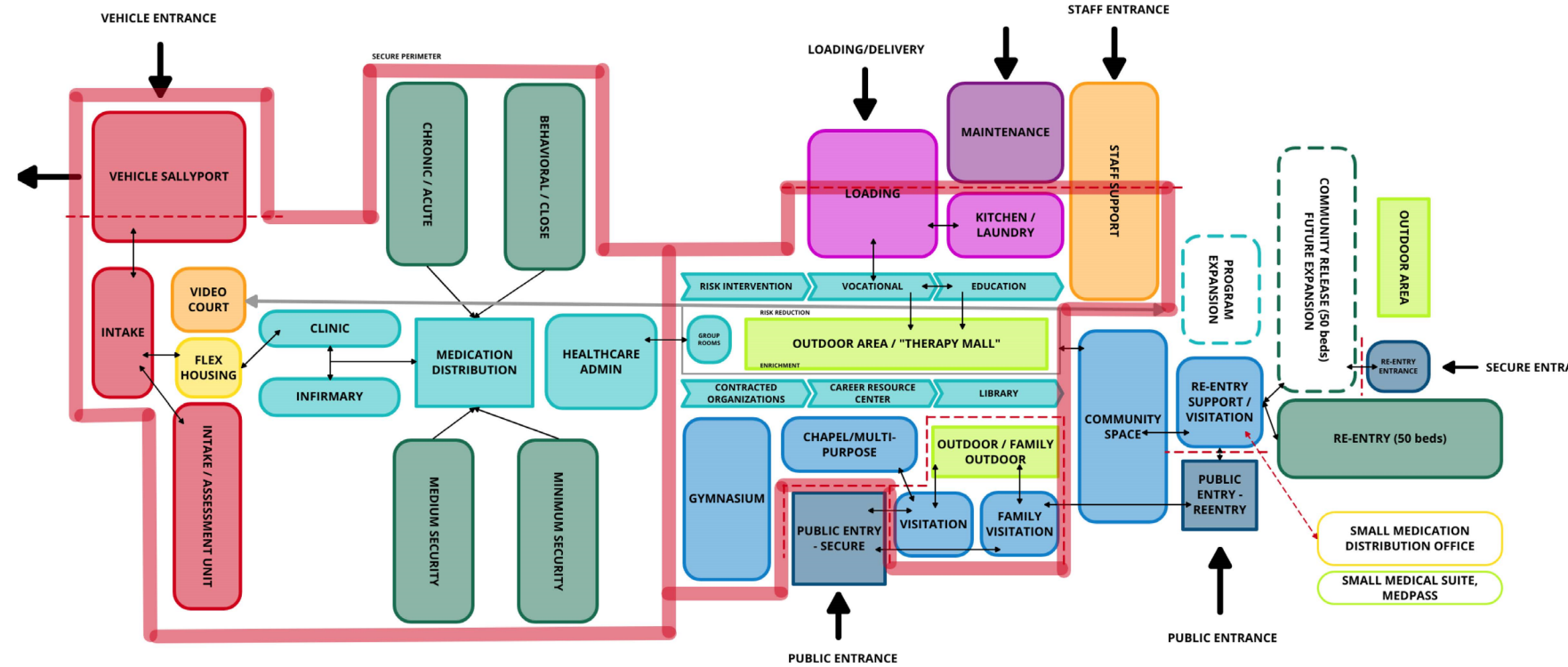

Co-locate the secure facility and re-entry facility

- * Operational efficiency
- * Staffing & service efficiency
- * Upfront cost savings
- * Shortened timeline to operation



VERMONT WOMENS CORRECTIONAL AND RE-ENTRY

LEGEND

-  CIRCULATION
-  COURTYARD
-  MAINTENANCE
-  LIVING AREA
-  SHOWERS
-  SLEEPING AREA
-  TREATMENT SUPPORT



VERMONT WOMENS CORRECTIONAL AND RE-ENTRY FACILITY



HC-100

LONG TERM & ACUTE MENTAL HEALTH HOUSING CONCEPT

1/16" = 1'-0"
2023-01-19 2:10:43 PM
00.00000.00



freeman | french | freeman

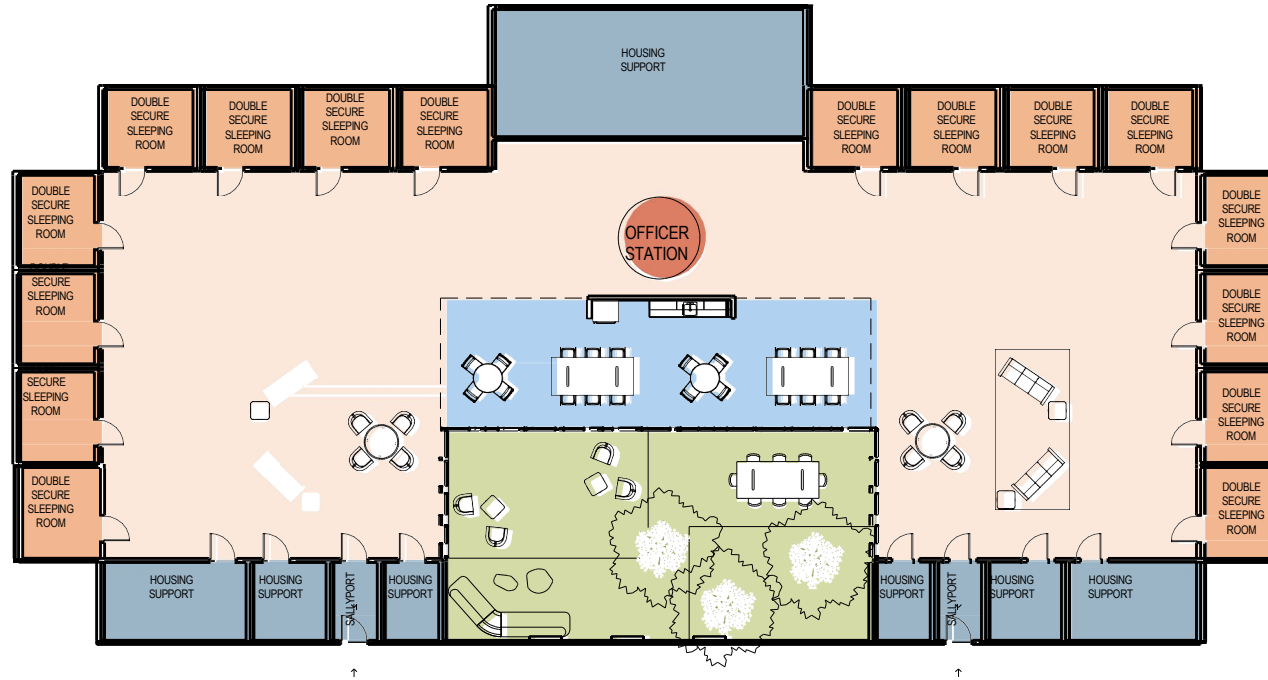

VERMONT WOMENS CORRECTIONAL AND RE-ENTRY FACILITY

SECURE RESIDENTIAL TREATMENT FACILITY

SECURE FACILITY						COMBINED	RE-ENTRY		
RATED BED CAPACITY			ADDITIONAL OPERATIONAL BED CAPACITY				RATED CAPACITY		
UNIT	CAPACITY (BEDS)	CONFIGURATION	UNIT	CAPACITY (BEDS)	CONFIGURATION		UNIT	CAPACITY (BEDS)	CONFIGURATION
CLOSE	8	SINGLE, SECURE SLEEPING ROOM	INTAKE	7	2 SINGLE, 2 GROUP (4) HOLDING CELLS	COMMUNITY RELEASE (WORK RELEASE / RE-ENTRY)	30	DOUBLE SLEEPING ROOM, POD CONFIGURATION OF 10 BEDS	
MEDIUM	40	DOUBLE SECURE SLEEPING ROOM	INCAP	2	1 SINGLE SECURE SLEEPING ROOM	RE-ENTRY (EXPANSION)	(50 BEDS)	DOUBLE SLEEPING ROOM, POD CONFIGURATION OF 10 BEDS	
MINIMUM	40	DOUBLE SLEEPING ROOM	ASSESSMENT	10	DOUBLE SECURE SLEEPING ROOM				
LONG TERM/CHRONIC MEDICAL	5	DOUBLE SECURE SLEEPING ROOM (SPACE FOR (CAREGIVER))	INFIRMARY	4	SINGLE ISOLATION				
ACUTE MENTAL HEALTH	5	SINGLE SECURE SLEEPING ROOM, WITH SUBDAYROOM	FLEX HOUSING	4	2 SECURE SLEEPING ROOMS WITH 2 BEDS				
BEHAVIORAL MENTAL HEALTH	10	SINGLE CELLS WITH SUBDAYROOM							
HONORS HOUSING	20	POD OF 20, SINGLE SLEEPING ROOM							
RATED BED CAPACITY	128		ADDITIONAL OPERATIONAL BED CAPACITY	27		RATED BED CAPACITY	30		